

**NOTE:**

UNBRACKETED DIMENSIONS (IN)  
BRACKETED DIMENSIONS (mm)

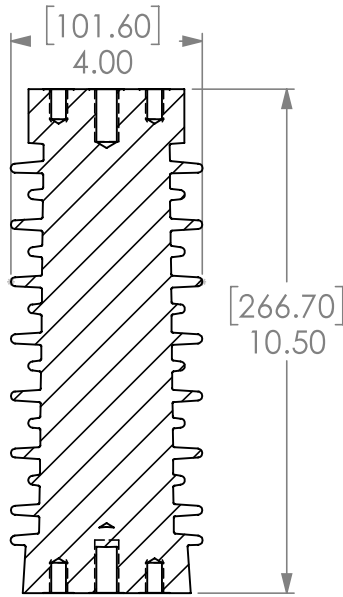

TECHNICAL REQUIREMENTS:	
CANTILEVER STRENGTH:	2000 (lbs)
TENSILE STRENGTH:	2000 (lbs)
COMPRESSION STRENGTH:	20000 (lbs)
NEMA VOLTAGE RATING:	34kV
60 HERTZ WITHSTAND - DRY:	95kKV
60 HERTZ WITHSTAND - WET:	80kKV
IMPULSE WITHSTAND:	150kV
MATERIAL:	CYCLOALIPHATIC EPOXY
APPLICABLE STANDARD:	ANSI C29.10-1989

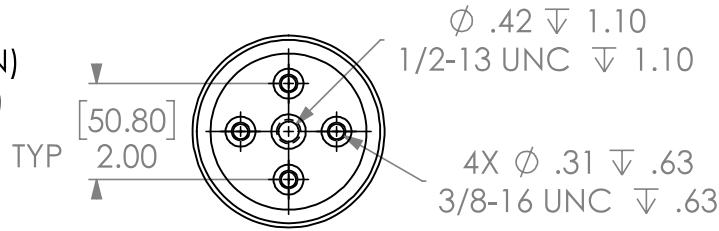
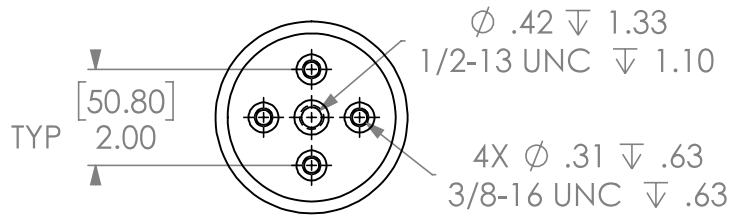

MV POWER LLC  
 2811 Hastings Road  
 Eric, PA 16506  
 Tel: 814-520-6385  
 Email: info@mvpower.us  
 Web: www.mvpower.us

REV. #:	
DRAWN BY: Anthony Dietz	Date: 07/30/2020
REVISED BY: Name	Date: 00/00/0000
MATERIAL:	CYCLOALIPHATIC EPOXY
FINISH:	

**DESCRIPTION:** INDOOR BUS SUPPORT

SIZE	PART NO.	REV
<b>A</b>	A-20-10.5-OC	

**DO NOT SCALE DRAWING**

SCALE: NTS WEIGHT: 6.35 LBS

SHEET 1 OF 1